

**AERODROME CHART-HOTSPOT**

ARP  
26° 49' 27.02" N  
075° 48' 08.91" E

ELEV. : 1268 ft.

TWR 124.3

**JAIPUR, INDIA**  
**JAIPUR INTERNATIONAL AIRPORT**

RWY	DIRECTION (MAG.)	THR. CO-ORDINATES	THR. ELEV.	BEARING STRENGTH
08	084°	26° 49' 22.88" N 075° 47' 57.42" E	1267	FROM BEGINNING TO 2757M : 71/F/B/W/T REMAINING 650M OF RWY : 85/R/B/W/T
26	264°	26° 49' 34.41" N 075° 50' 00.14" E	1248	FROM BEGINNING TO 650m : 85/R/B/W/T REMAINING 2757m OF RWY : 71/F/B/W/T

DATUM: WGS 84  
GEOID MODEL: EGM 2008  
ELEVATIONS IN FEET  
DIMENSIONS IN METRES  
RWY BEARINGS ARE MAGNETIC

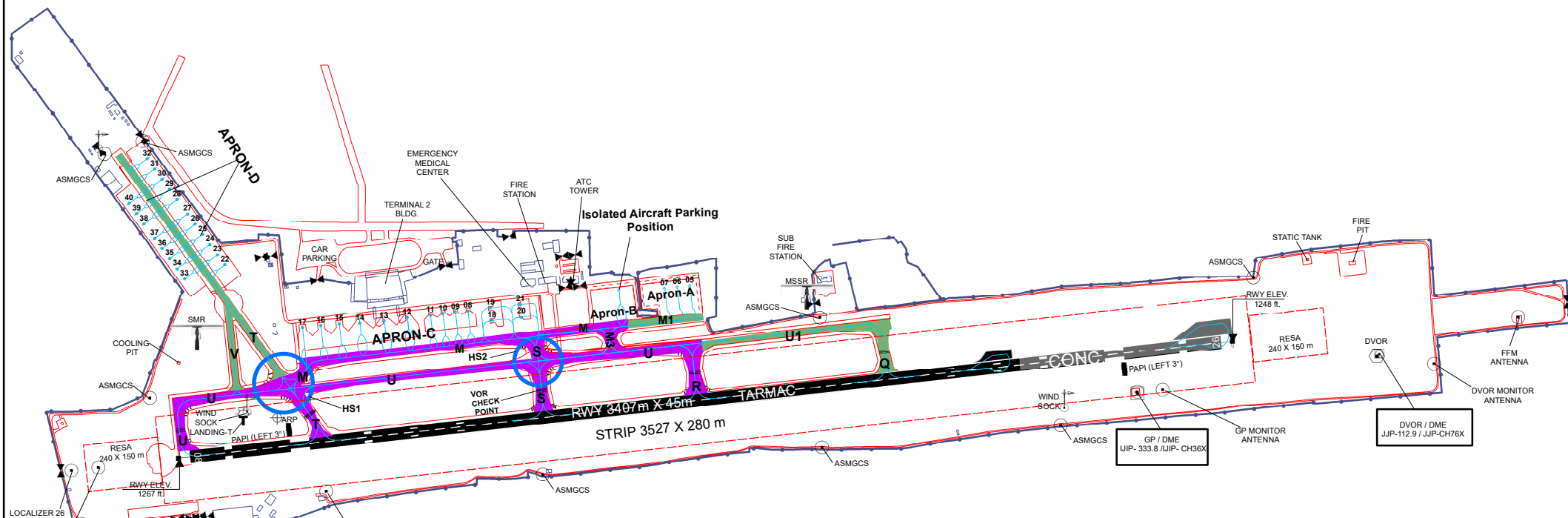
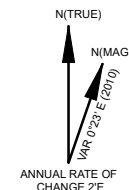

Pilot must exercise caution while crossing Hot spot	
HS1	Intersection of TWY U with TWY T & TWY M
HS2	Intersection of TWY S with TWY M & TWY U

LEGEND	
FOLLOW LINE	
VOR CHECK POINT	
RUNWAY HOLDING POSITION	

LEGEND	
TAXIWAY	
TWY FOR AIRCRAFT UPTO ICAO CODE "E"	
TWY FOR AIRCRAFT UPTO ICAO CODE "C"	
RUNWAY PAVEMENT	
RIGID	
FLEXIBLE	

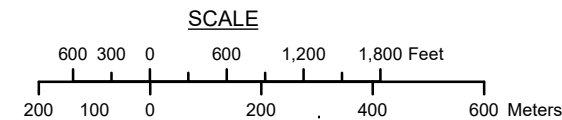

**MARKING AIDS RUNWAY 08/26**

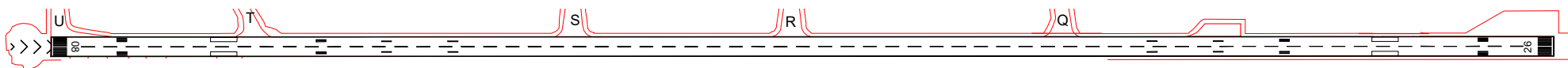

NOTE:  
1. AERONAUTICAL GROUND LIGHTS ARE NOT SHOWN IN THIS CHART.